

Zachte klauwen (nok/groef)

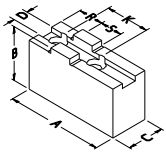

recht

TYPE	A	B	C	D	K	R	S	BOUT	KG/SET	MATERIAAL
CU25	125	55	30	12	40	36	20	M12	3.6	staal
CU251	90	60	40	12	40	26	20	M12	3.9	staal
CU252	125	60	40	12	40	26	20	M12	5.8	staal
CU253	125	80	40	12	40	26	20	M12	7.5	staal
CU254	125	100	40	12	40	26	20	M12	9.6	staal
CU255	125	125	40	12	40	26	20	M12	12.0	staal
DP25	90	60	60	12	40	26	20	M12	6.2	staal
CU257	90	60	80	12	40	26	20	M12	8.5	staal
CW25	125	60	40	12	40	36	20	M12	2.0	aluminium

segment omkeerbaar

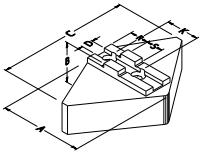

TYPE	A	B	C	D	K	R	S	BOUT	KG/SET	MATERIAAL
CQ25	102	64	170	12	40		20	M12	20.0	staal
HT25	102	64	170	12	40		20	M12	8.4	aluminium

segment

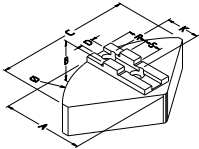

TYPE	A	B	C	D	K	R	S	BOUT	KG/SET	MATERIAAL
CF25	123	51	254Ø	12	40		20	M12	17.0	staal

Harde klauwen (nok/groef)

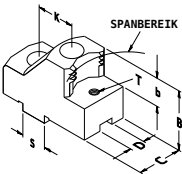

grijpklauwen - buitenspanning

TYPE	SPANBEREIK	GRONDKLAUW POSITIE	B	C	D	K	S	B	T	KG/SET
LY40	52 - 131	1	59	50	12	54	26	25	M8	4.0
	100 - 216	2								
LY43	152 - 257	1								3.2
	225 - 343	2								

omkeerbaar

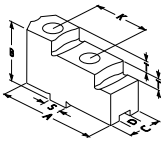

TYPE	A	B	C	D	K	S	T	BOUT	KG/SET
GX25	90	55	30	12	40	20	14	M12	1.9

Grondklauwen

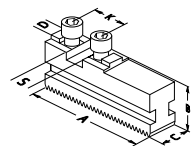

TYPE	A	B	C	D	K	S	BOUT	KG/SET
GBK315	115	43	32	12	40	20	M12	2.7

Zachte monoblok klauwen

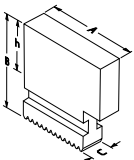

TYPE	A	B	C	h	KG/SET
UVB315	118	100	32	66	6.6